

Parts & Service Manual

1989

E3-10B401/R3-10B401 110-4 4-SPEED

E3-12K602/R2-12K601 112-6 6-SPEED

899199



INTRODUCTION PAGE

1. How to use this parts manual

- 1.1. The 100-Series parts manual is divided into major sections arranged in the sequence as outlined on the following page. Major sections are subdivided into smaller groups of parts, each with its own illustration and illustration reference numbers.
- 1.2. Illustrated items are numerically keyed to the parts listing on the facing page. Illustrations are repeated when the parts list is too long for one page. Figure numbers are located at the bottom of each illustration and also at the beginning of each description column. Item numbers are numerically keyed to their respective illustrations.
- 1.3. When an (X) appears in the quantity (Qty) column use only if applicable, or as required to meet tolerances.

2. To locate parts

When function, use or location is known:
Refer to the List of Illustrations to locate the proper illustration.

3. Service Information

- 3.1. Special notes recorded on illustrations:
Refer to operator's manuals and service bulletins for detailed information.
- 3.2. Standard torque values for fasteners:
Refer to Section 13 - Torque Specifications.
- 3.3. Paint:
Refer to Section 13 - Paint

Product information and specifications are shown herein as of the time of printing. Wheel Horse Products, Inc. reserves the right to change product specifications, designs and standard equipment without notice and without incurring obligation.



Wheel Horse

LIST OF ILLUSTRATIONS

1

TITLE	FIGURE NUMBER	PAGE
Section 1		
Frame	1-1	2
Section 2		
Mechanical Transmission 4 & 6 Speed	2-1	4
Section 3		
Front Axle and Steering	3-1	6
Section 4		
Clutch, Brake Linkage	4-1	8
Section 5		
Sheet Metal	5-1	10
Section 6		
Engine & Exhaust Systems	6-1	12
Section 7		
Fuel System	7-1	14
Section 8		
Electrical System	8-1	16
Section 9		
Wheels and Tires	9-1	20
Section 10		
Drive Belt and Pulleys	10-1	22
PTO Clutch, Pulleys and Controls	10-2	24
Section 11		
Seat and Suspension	11-1	26
Decals and Miscellaneous	11-2	28
Section 12		
Mower Deck and Front Mount	12-1	32
Spindle, Pulleys and Mower Drive Belt	12-2	34
Section 13		
Torque Specifications, Fuel Line, Fasteners, Paint		36

SECTION 1 - FRAME

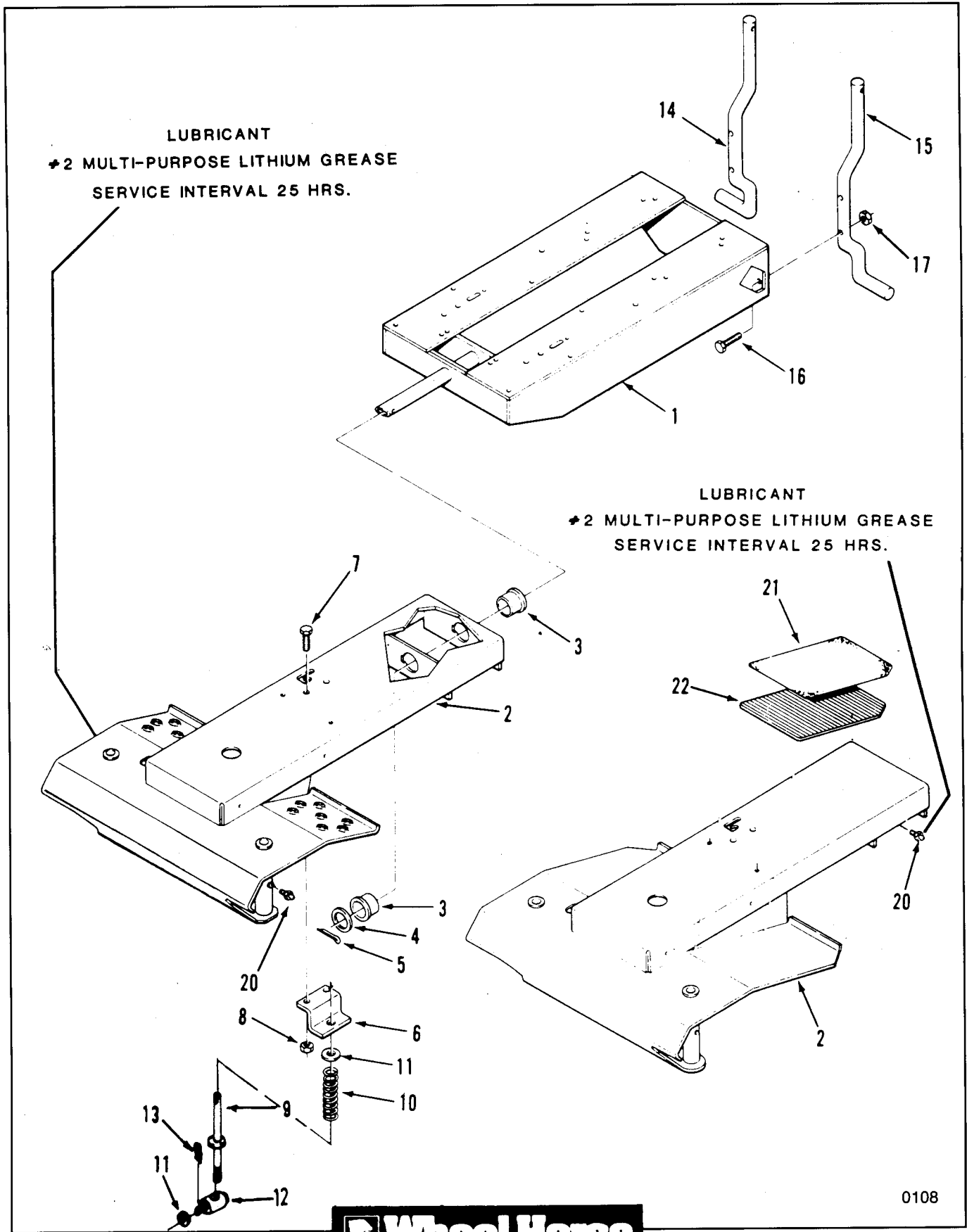

Figure 1-1 Frame

SECTION 1 - FRAME

3

ITEM	PART NUMBER	DESCRIPTION	100-Series
		Figure 1-1	
		FRAME	
1	112502	Rear Frame	1
2	111303	Front Frame	1
3	110311	Flange Bearing	2
4	110426	Special Washer	X
5	932037	Cotter Pin 3/6 x 1-3/4	1
6	110406	Mower Hanger Bracket	1
7	908033	Bolt 3/8-16 X 7/8	2
8	915663	E.S. Nut 3/8-16	2
9	112922	Rod Assembly	1
10	109229	Compression Spring	1
11	920039	Washer 3/8 VS	2
	915113	Nut 3/8-16 (Not illustrated)	1
12	110656	Trunnion	1
13	932008	Cotter Pin 3/32 x 3/4	1
14	111088	Rear Rod RH	1
15	111087	Rear Rod LH	1
16	911450	Bolt 5/16-18 x 1-1/2 HHCS 5/16 - 18 x 3/4	4
17	112536	Locknut 5/16-18	4
20	MW1455	Grease Fitting	2
21	111300	Sandpaper Footrest Mat RH 110-4	1
	111299	Sandpaper Footrest Mat LH 110-4	1
22	111324	Rubber Footrest Mat RH 112-6	1
	111325	Rubber Footrest Mat LH 112-6	1

SECTION 2 - MECHANICAL TRANSMISSION

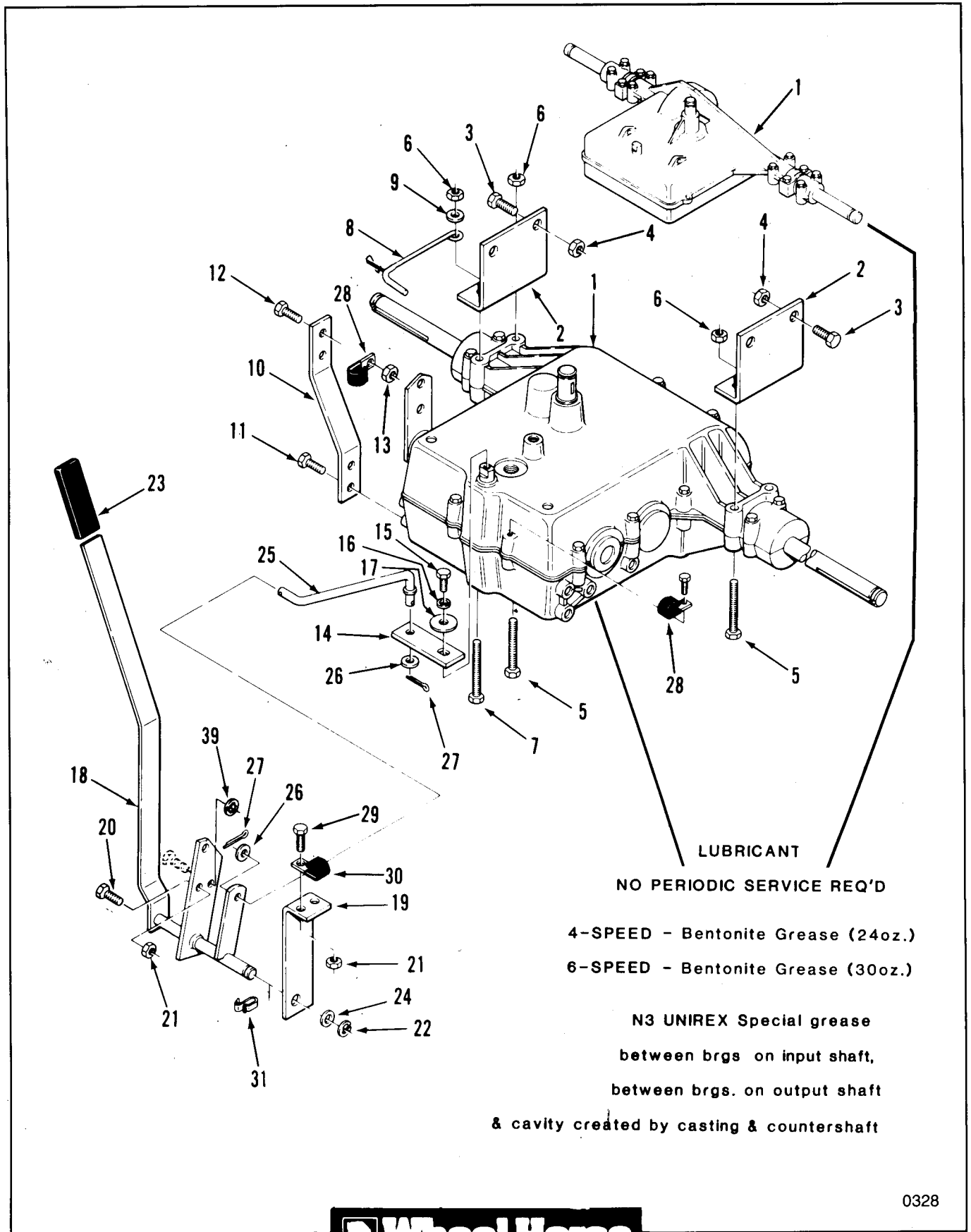

Figure 2-1 Mechanical Transmission

SECTION 2 - MECHANICAL TRANSMISSION

ITEM	PART NUMBER	DESCRIPTION	100-Series
Figure 2-1			
MECHANICAL TRANSMISSION			
1	112137*	Peerless Transmission (900-028) 110-4 Only	1
	112102*	Peerless Transmission (920-007) 112-6 Only	1
2	110326	Rear Axle Bracket	2
3	913183	Bolt 3/8-16 x 7/8 Grd 5	4
4	915663	E.S. Nut 3/8-16	4
5	908025	Bolt 5/16-18 x 2-1/2	3
6	915662	E.S. Nut 5/16-18	4
7	908026	Bolt 5/16-18 x 2-3/4	1
8	110848	Brake Stop Rod	1
9	920008	Washer 5/16 SAE	5
10	110836	Torque Strap 110-4	1
	112138	Torque Strap 112-6	1
11	926720	Swage Form Hex Bolt 5/16-18 x 3/4	2
12	908017	Bolt 5/15-18 x 3/4	2
13	915662	E.S. Nut 5/16-18	2
14	110330	Lower Shift Lever	1
15	908153	Eslok Bolt 1/4-28 x 7/8	1
16	920081	Lockwasher 1/4	1
17	104869	Special Washer	1
18	111109	Shift Lever	1
19	111106	Shift Support	1
20	908017	Bolt 5/16-18 x 3/4	4
21	915662	E.S. Nut 5/16-18	4
22	5701	E-Ring	1
23	102597	Grip	1
24	920259	Washer 3/8 SAE	X
25	112289	Lower Shift Rod 110-4	1
	112128	Lower Shift Rod 112-6	1
26	920008	Washer 5/16 SAE	2
27	932008	Cotter Pin 3/32 x 3/4	2
28	111357	"J" Clip (1/4 Bolt Size)	2
29	913160	Bolt 5/16-18 x 3/4 Grd 5	2
30	111392	"J" Clip (5/16 Bolt Size)	1
31	519337	Clip	1
39	920155	Internal Tooth Lockwasher 5/16	1

* Transmission and transmission parts are available through manufacturer's distribution system, using model and spec. numbers shown above. WHEEL HORSE part numbers are listed for cross reference purposes only; transmission and transmission parts are not available through the WHEEL HORSE distribution system.

SECTION 3 - FRONT AXLE AND STEERING

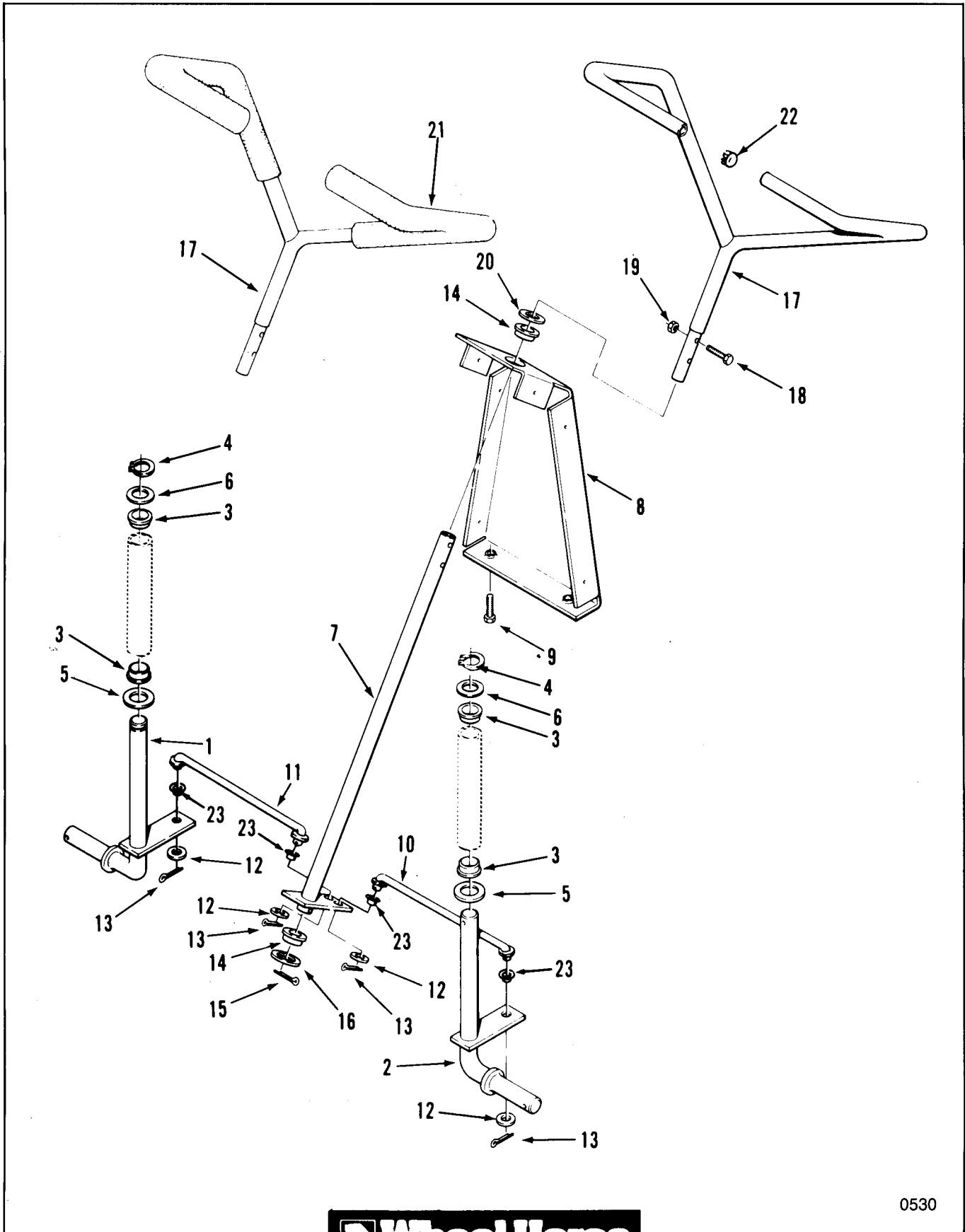

0530



Figure 3-1 Front Axle and Steering

SECTION 3 - FRONT AXLE AND STEERING

7

ITEM	PART NUMBER	DESCRIPTION	100-Series
Figure 3-1			
FRONT AXLE AND STEERING			
1	113384	Spindle RH	1
2	113383	Spindle LH	1
3	111102	Bushing	4
4	104822	Retaining Ring 3/4	2
5	920015	Washer 3/4 SAE	2
6	1278	Shim Washer .050	X
7	112106	Steering Shaft	1
8	110320	Upper Steering Support	1
9	926720	Swage Form Bolt 5/26-18 x 3/4	2
10	112129	Tie Rod LH	1
11	112130	Tie Rod RH	1
12	920237	Special Washer	4
13	932008	Cotter Pin 3/32 x 3/4	4
14	110324	Bushing	2
15	932018	Cotter Pin 1/8 x 1-1/4	1
16	109262	Washer	1
17	110889	Steering Wheel	1
18	908006	Bolt 1/4-20 x 1-1/4	2
19	915661	E.S. Nut 1/4-20	2
20	920215	Special Washer	X
21	110892	Steering Wheel Grips 112-6	2
22	112302	Button Plug 110-4	2
23	112108	Bushing	4

SECTION 4 - CLUTCH, BRAKE LINKAGE

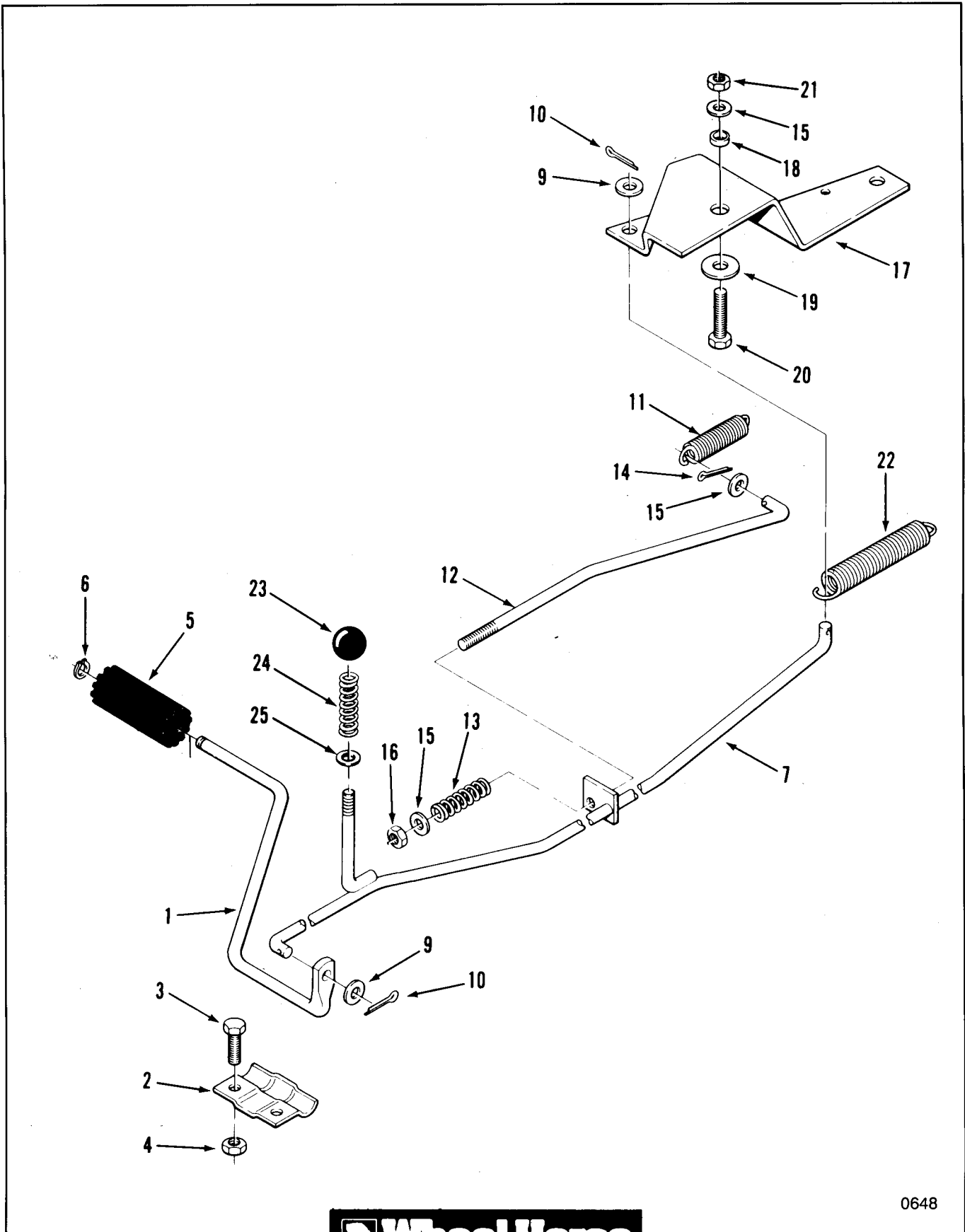

0648



Figure 4-1 Clutch, Brake Linkage

SECTION 4 - CLUTCH, BRAKE LINKAGE

9

ITEM	PART NUMBER	DESCRIPTION	100-Series
Figure 4-1			
CLUTCH, BRAKE LINKAGE			
1	110340	Clutch/Brake Pedal Rod	1
2	108861	Pedal Support Bracket	1
3	908032	Bolt 3/8-16 x 3/4	2
4	915663	E.S. Nut 3/8-16	2
5	108854	Clutch/Brake Pedal Pad	1
6	106649	Grip Ring	1
7	111715	Clutch Rod	1
9	920009	Washer 3/8 SAE	2
10	932008	Cotter Pin 3/32 x 3/4	2
11	103628	Extension Spring	1
12	110911	Brake Rod	1
13	109832	Brake Spring	1
14	932008	Cotter Pin 3/32 x 3/4	1
15	920009	Washer 3/8 SAE	3
16	915663	E.S. Nut 3/8-16	1
17	110363	Clutch Traction Lever	1
18	111108	Spacer	1
19	2844	Special Washer	1
20	908035	Bolt 3/8-16 x 1/4	1
21	915663	E.S. Nut 3/8-16	1
22	111159	Extension Spring	1
23	111070	Round Knob	1
24	104841	Spring	1
25	107675	Nylon Washer	1

SECTION 5 - SHEET METAL

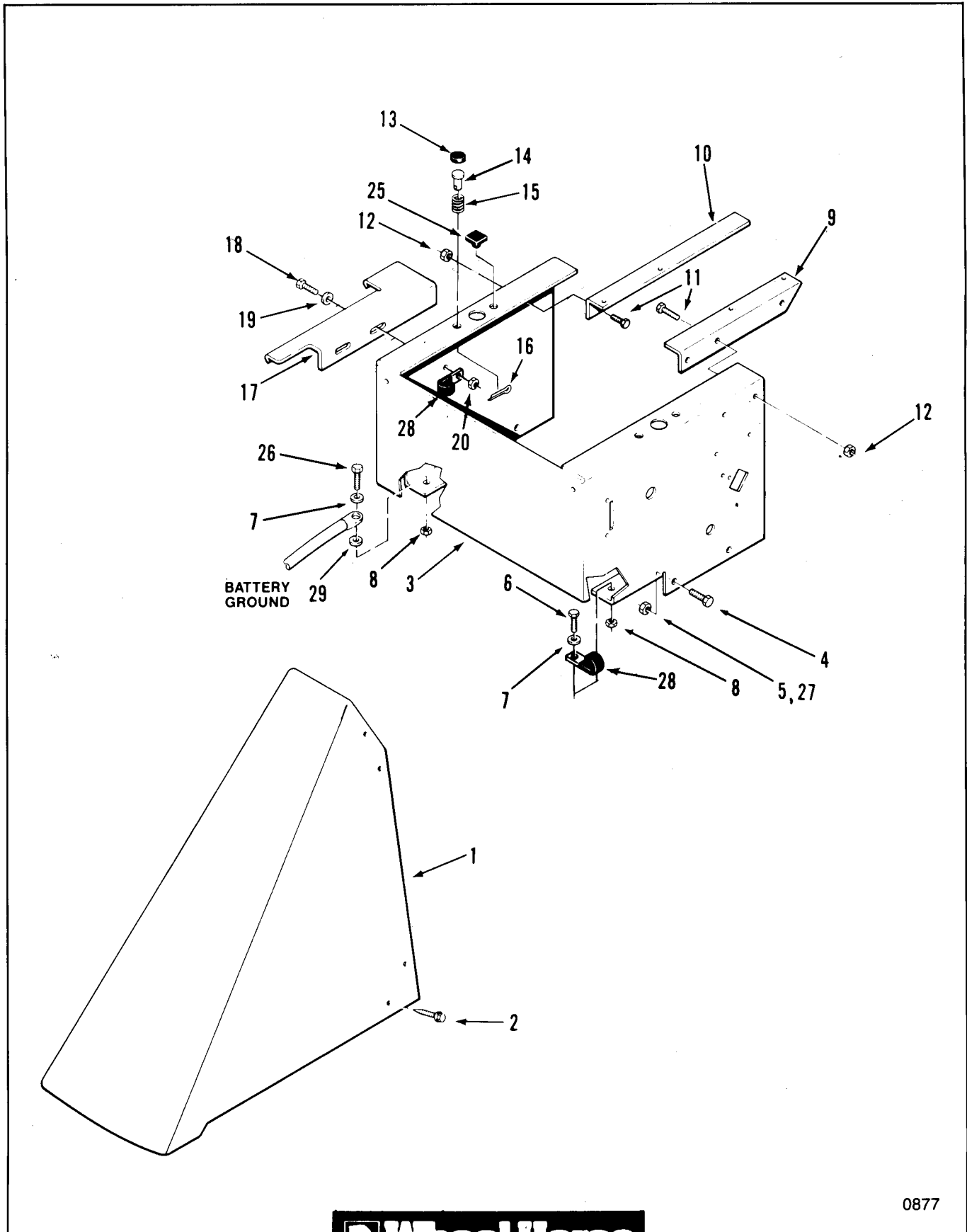

0877



Figure 5-1 Sheet Metal

SECTION 5 - SHEET METAL

ITEM	PART NUMBER	DESCRIPTION	100-Series
		Figure 5-1	
		SHEET METAL	
1	110323	Steering Shroud Cover	1
2	110430	Hex Washer Head Self Tapping Screw	10
3	114283	Seat Support	1
4	913183	Bolt 3/8-16 x 7/8 GRD 5	4
5	915663	E.S. Nut 3/8-16	3
6	908017	Bolt 5/16-18 X 3/4	1
7	920008	Washer 5/16 SAE	2
8	915662	E.S. Nut 5/16-18	2
9	110353	Fuel Tank Support Angle LH	1
10	110354	Fuel Tank Support Angle RH	1
11	908015	Bolt 5/16-18 X 1/2	4
12	915112	Eslok Nut 5/16-18	4
13	106331	Neoprene Cup	2
14	106449	Pin	2
15	104841	Spring	2
16	932008	Cotter Pin 3/32 x 3/4	2
17	110470	Shift Plate	1
18	908017	Bolt 5/16-18 x 3/4	2
19	920008	Washer 5/16 SAE	2
20	915662	E.S. Nut 5/16-18	2
25	111071	Bumper	2
26	908019	Ground Wire Bolt 5/16-18 x 1	1
27	915113	Eslok Nut 3/8-16	1
28	8830	„J” Clip (3/8 Bolt Size)	1
29	920155	Internal Tooth Lockwasher 5/16	1

LUBRICANT

SEE OWNER'S MANUAL FOR OIL VISCOSITY & TYPE

110 - 1 1/8 QTS.

112 - 1 1/2 QTS.

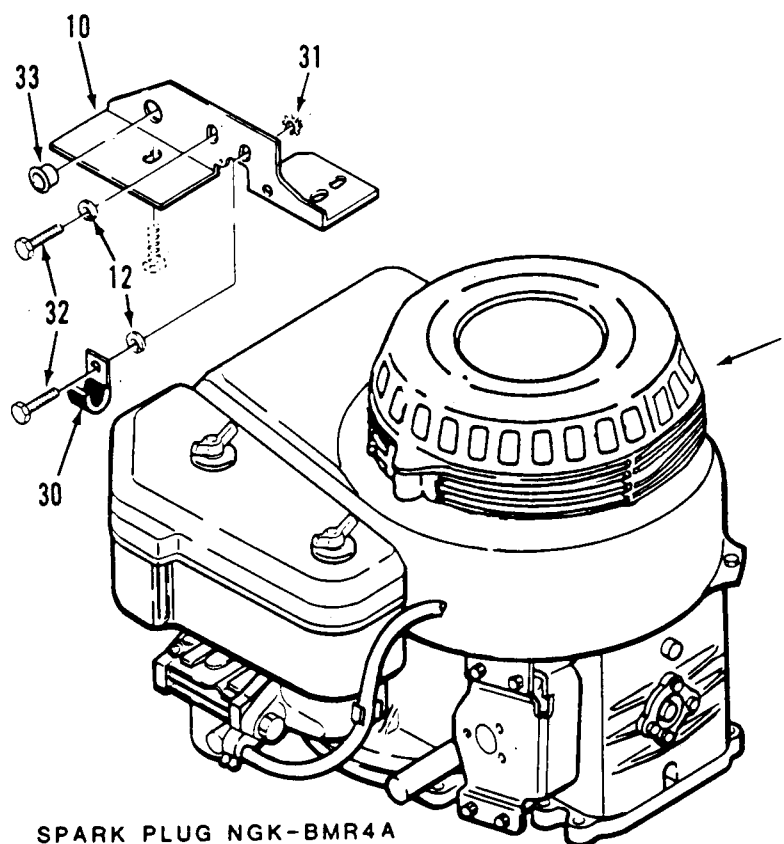

SPARK PLUG NGK-BMR4A
GAP .025

0979

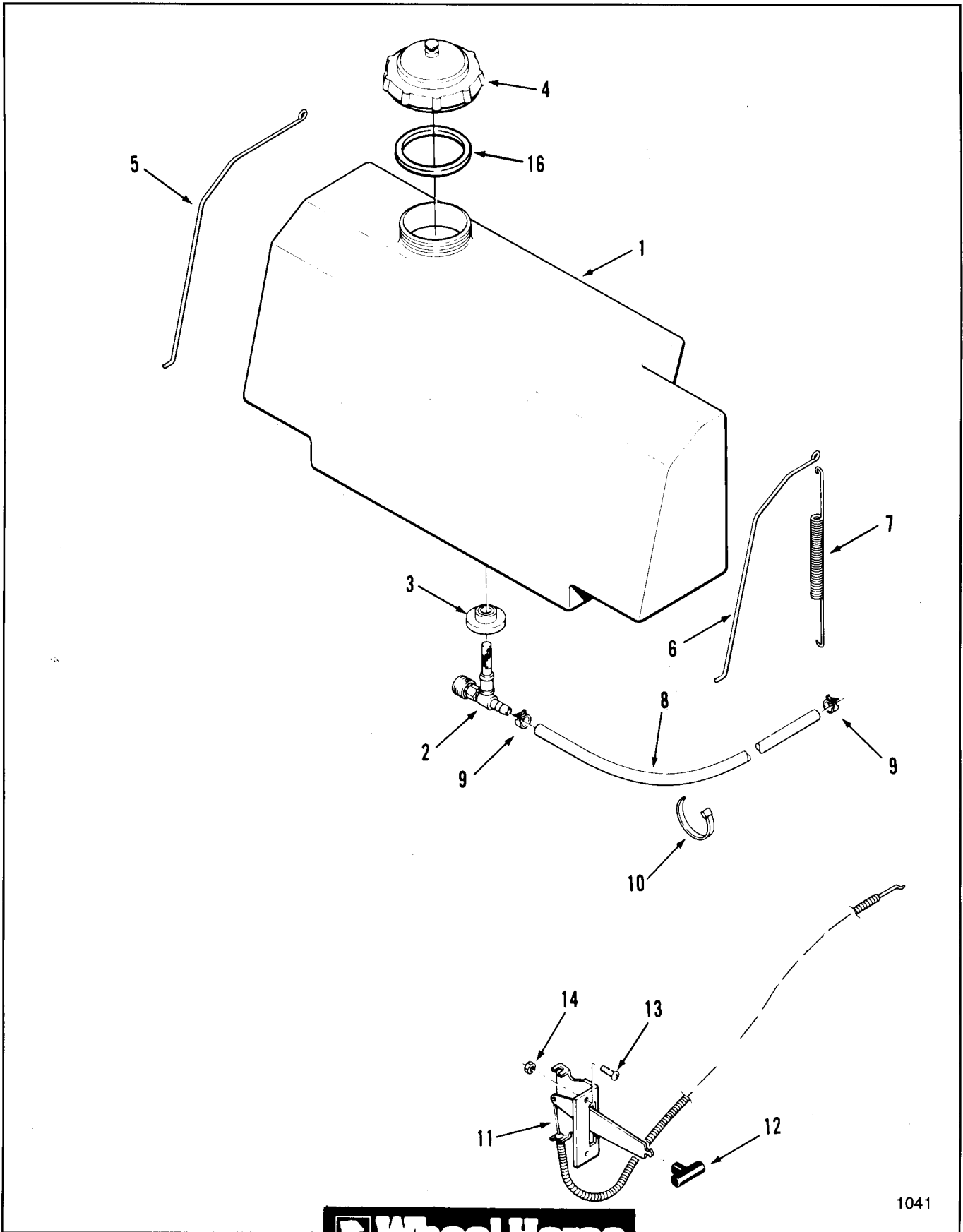

Figure 6-1 Engines

SECTION 6 - ENGINES & EXHAUST SYSTEMS

ITEM	PART NUMBER	DESCRIPTION	100-Series
		Figure 6-1	
		ENGINES	
1	114887	Engine - 10 HP Briggs & Stratton I.C. Model 256707 Type 0117 01	1
	113484	Engine - 12.5 HP Kawasaki Model FB460V Type BS-22 112-6 Only (see Sections 9-2 thru 9-8 for complete service info)	1
	112676	Drain Pipe (110-4 only) used on engine (not illustrated)	1
	5224	Pipe Cap (110-4 only) used on engine (not illustrated)	1
	908021	Bolt 5/16-18 X 1 1/2 (110-4 only) used on engine (not illustrated)	2
	908023	Bolt 5/16-18 X 2 (110-4 only) used on engine (not illustrated)	1
	920008	Washer 5/16 SAE (110-4 only) used on engine (not illustrated)	5
	915662	E.S. nut 5/16-18 (110-4 only) used on engine (not illustrated)	5
	915112	Eslok Nut (110-4 only) used on engine (not illustrated) 5/16-18	1
10	114019	Engine Head Bracket 12.5 H.P. Model	1
	115962	Engine Head Bracket 10 H.P. Model	1
	915112	Nut 5/16-18 (not illustrated)	2
12	920082	Lockwasher 5/16 (4 used on 112-6)	2
	920009	Washer 3/8 SAE (not illustrated)	2
30	8830	Clip	1
31	920123	External Tooth Lockwasher 5/16	2
32	112988	Bolt 8M x 1.25 C x 16 (112-6 only)	2
33	938031	Bushing (112-6 only)	1
	113497	Exhaust manifold 112-6 (Not illustrated)	1
	113767	Manifold clamp (Not illustrated) (112-6 only)	1
	113485	Muffler (Not illustrated) (112-6 only)	1
	810577	Engine Manual 10 H.P. Model	
	810556	Engine Manual 12.5 H.P. (French)	
	810559	Engine Manual 12.5 H.P. (German)	
	810447	Engine Manual 12.5 H.P. (K/W)	

SECTION 7 - FUEL SYSTEM



1041



Figure 7-1 Fuel System

SECTION 7 - FUEL SYSTEM

ITEM	PART NUMBER	DESCRIPTION	100-Series
Figure 7-1			
FUEL SYSTEM			
1	114194	Fuel Tank (includes items 2 & 3)	1
2	104048	Fuel Tank Fitting w/Screen	1
3	104047	Bushing	1
4	110352	Fuel Tank Cap w/ Gasket	1
5	110925	Fuel Tank Retainer RH	1
6	110926	Fuel Tank Retainer LH	1
7	110927	Spring	2
8	100088	Fuel Hose 9' (24 cm) 110-4 Only	1
	105442	Fuel Hose 18" (46 cm) 112-6 Only	1
9	108898	Hose Clamp	2
10	100571	Cable Tie	1
11	110878	Choke/Throttle Control 110-4 Only	1
	112777	Choke/Throttle Control 112-6 Only	1
12	107045	Choke Throttle Knob	1
13	910792	Pan Head Screw nr. 10-24 x 1/2	2
14	915740	E.S. Nut nr. 10-24	2
16	106931	Fuel Cap Gasket	1

SECTION 8 - ELECTRICAL SYSTEM

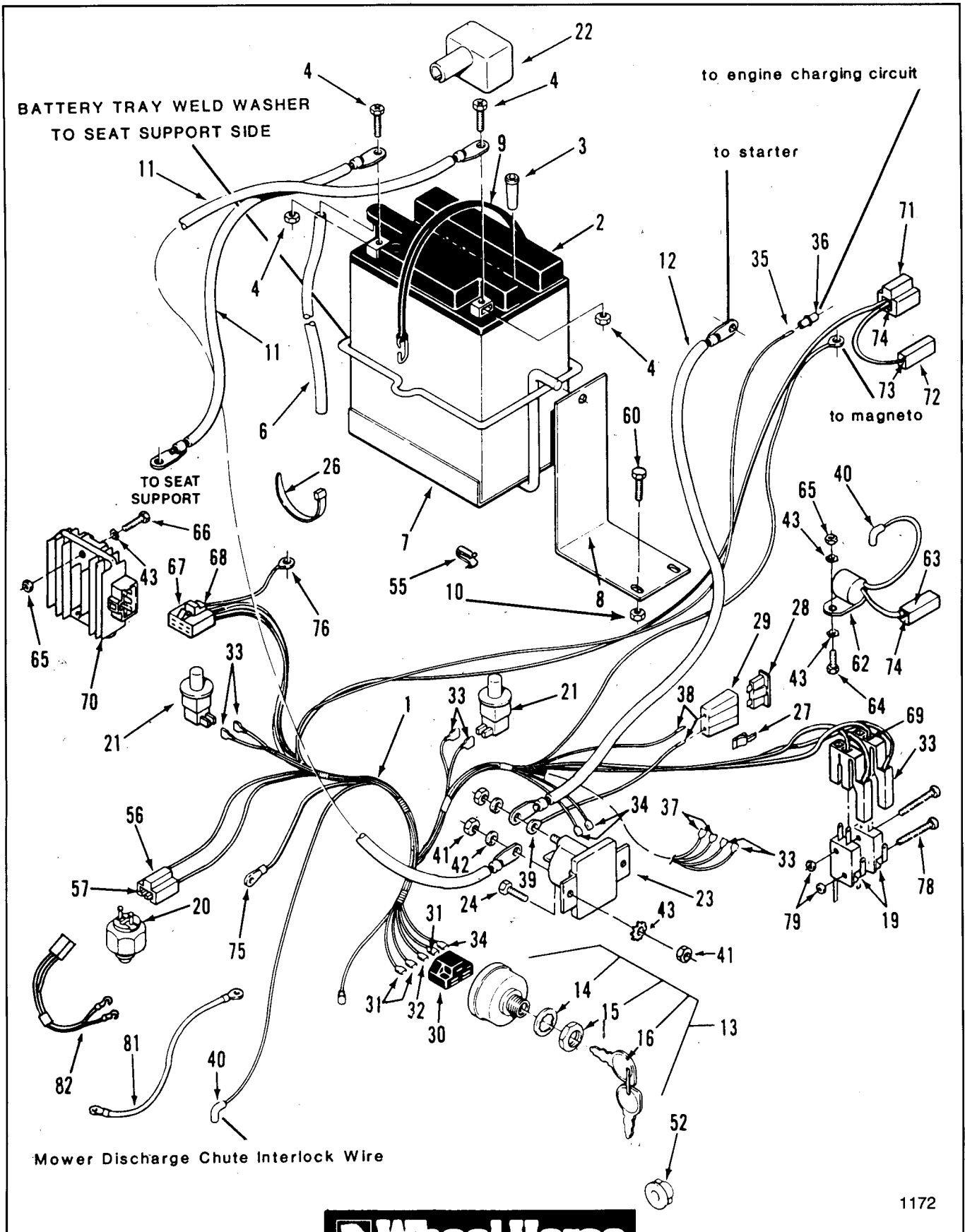

Figure 8-1 Electrical System

SECTION 8 - ELECTRICAL SYSTEM

ITEM	PART NUMBER	DESCRIPTION	100-Series
Figure 8-1 ELECTRICAL SYSTEM			
1	114834	Wiring Harness 110-4 Only	1
	114872	Wiring Harness 112-6 Only	1
2	110379	Battery	1
3	110427	Battery Acid Adapter	1
4	111185	Battery Metric Nuts & Bolts Pkg	X
6	110424	Battery Drain Hose	1
7	111335	Battery Saddle Tray	1
8	111339	Battery Tray Bracket	1
9	111340	Battery Hold-Down Strap	1
10	915112	Eslok Nut 5/16-18	2
11	111341	Battery Ground Cable & Battery to Solenoid Cable	2
	112757	Battery to Solenoid (112-6 only)	1
12	111075	Solenoid To Engine Starter Cable (110-4 Only)	1
13	111215	Ignition Switch (includes items 14 & 15)	1
14	920160	Internal Lockwasher 5/8	1
15	101884	Nut 5/8-32	1
16	111220	Ignition Key (Set of 3)	1
19	114565	Interlock Switch	2
20	111365	Transmission Interlock Switch	1
21	109329	Seat Interlock Switch	2
22	111045	Cable Boot	1
23	110167	Solenoid (110-4 only)	1
24	960151	Whizlock Bolt 1/4-20 x 1/2 (110-4 Only)	2
26	100571	Cable Tie	4
27	109445	Fuse Body Mounting Clip	1
28	109355	15 Amp Fuse	1
	109102	25 Amp Fuse	1
29	109117	Fuse Holder	1
30	105302	Terminal Housing (Part of 1)	1
31	102651	Wire Terminal (Part of 1)	1
32	113090	Wire Terminal (Part of 1)	1
33	113124	Wire Terminal (Part of 1)	6
34	113088	Wire Terminal (Part of 1)	3
35	518074	Socket Contact (Part of 1)	1
36	107831	Body (Part of 1)	1
37	109378	Wire Terminal (Part of 1)	2
38	108995	Wire Terminal (Part of 1)	2
39	518007	Wire Terminal (Part of 1)	1
40	518246	Wire Terminal (Part of 1)	1
41	915111	Nut 1/4 - 20	4
42	920081	Lockwasher 1/4	2
43	920122	External Tooth Washer	6

SECTION 8 - ELECTRICAL SYSTEM

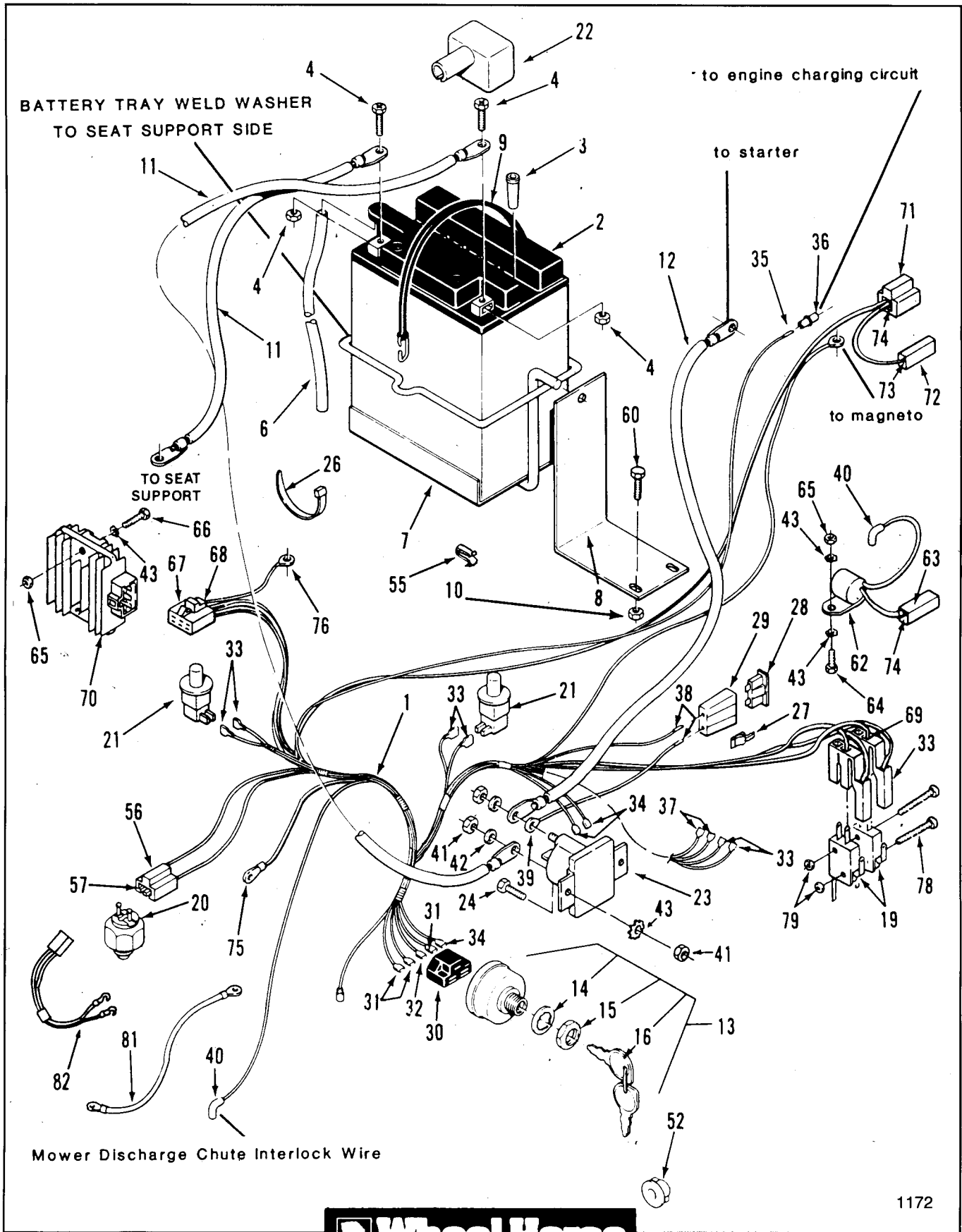

Figure 8-1 Electrical System

SECTION 8 - ELECTRICAL SYSTEM

ITEM	PART NUMBER	DESCRIPTION	100-Series
		Figure 8-1	
		ELECTRICAL SYSTEM (CONTINUED)	
	105490	Clamp (112-6 Only)	1
52	938031	Bushing Snap	1
55	8830	Clip	2
56	109357	Connector Body (Part of 1)	1
57	113206	Male Terminals (Part of 1)	2
60	908017	Hex Bolt 5/16-18 x 3/4	1
62	112691	Interlock Module (112-6 only)	1
63	104926	Connector (Part of item 62)	1
64	960152	Screw 1/4-20 x 5/8 (112-6 Only)	1
65	915661	Hex Jam Nut 1/4-20	3
66	960155	Whizlock Bolt 1/4-20 (112-6 Only)	2
67	112192	6 Term. Conn. 112-6 Only (Kawasaki nr. 59221-2099)	1
68	113089	Terminal 112-6 Only (Kawasaki nr. 21169-2055)	5
69	111498	3 Terminal Connector	2
70	KW10083	Voltage Reg. 112-6 Only (Kawasaki nr. 21066-2004)	1
71	112362	Connector 112-6 Only (Part of 1)	1
72	105302	Connector 112-6 Only (Part of 1)	1
73	113206	Tab Receptacle .250 x .032 (Part of 1)	1
74	113131	Tap Receptacle .248 x .032 (Part of 1)	4
75	113124	Ring Terminal 5/16 (Part of 1)	1
76	113126	Ring Terminal 1/4 (Part of 1)	1
78	910478	Screw nr. 4-40 x 1-1/4	2
79	915732	E.S. Nut nr. 4-40 112-6 Only	4
81	113921	Mower Ground Wire	1
82	111364	Wiring Harness	1

SECTION 9 - WHEELS AND TIRES

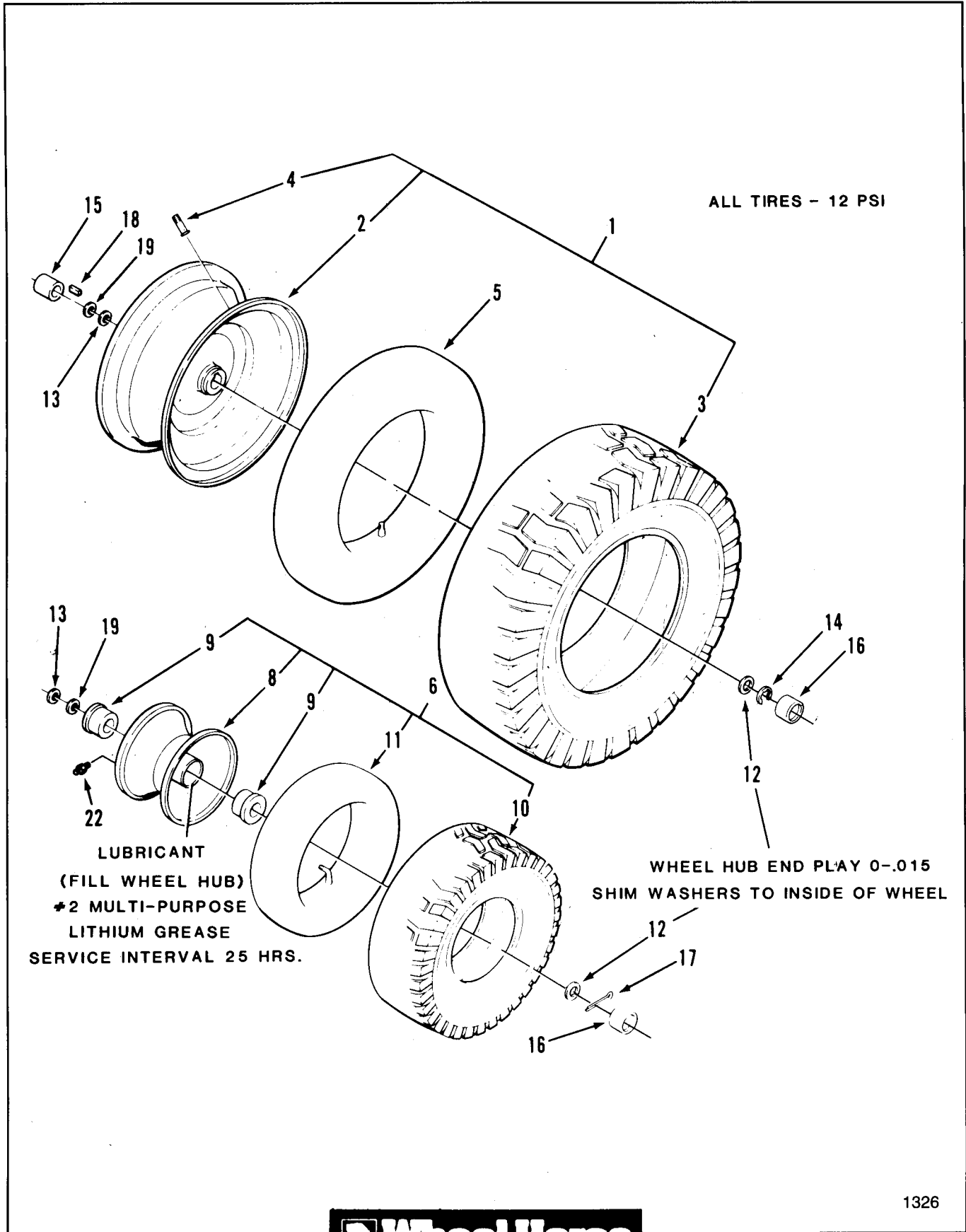
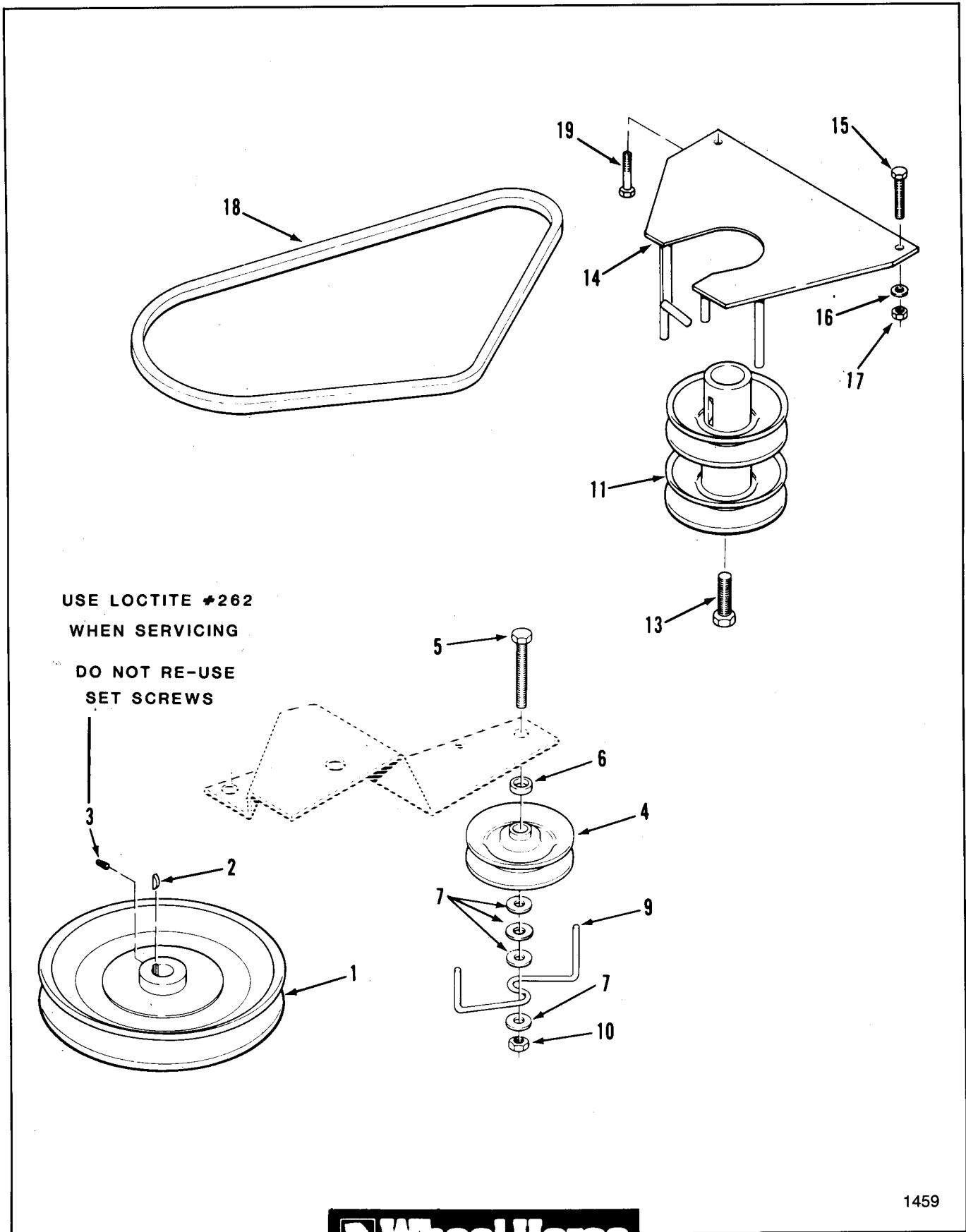

Figure 9-1 Wheels and Tires

SECTION 9 - WHEELS AND TIRES

ITEM	PART NUMBER	DESCRIPTION	100-Series
		Figure 9-1	
		WHEELS AND TIRES	
1	112195	Rear wheel and Tire	2
2	112196	Rear Wheel	2
3	9792	Rear Tire 16 x 6.50-8	2
4	5108	Valve Stem	2
5	105293	Inner Tube Service Only	X
6	113343	Front Wheel and Tire	2
8	113344	Frnt Wheel w/Bushings & Grease Fit	2
9	113342	Bushing	2
10	108444	Tire 4.10 x 3.50-4	2
11	100041	Front Tube Service	X
12	109262	Wheel Washer	4
13	920250	Shim Washer .050	X
14	104636	E-Ring	2
15	110387	LH Axle Spacer	2
16	109154	Hub Cap (Black)	2
	109261	Hub Cap	2
17	932018	Cotter Pin 1/8 x 1-1/4"	2
18	1120	Squars Key 3/16 x 1-3/4	2
19	5210	Washer .015	X



1459

Figure 10-1 Drive Belt and Pulleys

SECTION 10 - DRIVE BELT AND PULLEYS

ITEM	PART NUMBER	DESCRIPTION	100-Series
Figure 10-1			
DRIVE BELT AND PULLEYS			
1	111136	Transmission Pulley	1
2	937225	Nr. 9 Hi-Pro Key	1
3	909540	Square Head Set Screw	2
4	113112	V-Idler Pulley 8205	1
5	908038	Bolt 3/8-16 x 2	1
6	111108	Spacer	1
7	920039	Special Washer 3/8	4
9	110362	V-Idler Pulley Belt Guide	1
10	109779	Jam Nut 3/8-16	1
11	114113	Engine Pulley	1
13	112149	Eslok Bolt 10, x 1.5 x 30 (112-6 only)	1
	908196	Eslok Bolt 5/16 x 3/4 (110-4 only)	1
14	114262	Engine Pulley Belt Guide	1
15	908022	Bolt 5/16-18 x 1-3/4 (110-4 only)	2
16	920008	Washer 5/16 SAE	2
17	915662	E.S. Nut 5/16-18	2
18	113105	Transmission Drive Belt (33,1")	1
19	112147	Bolt 8M x 1.25 x 25 112-6 Only	2

SECTION 10 - PTO CLUTCH, PULLEYS, AND CONTROLS

25

ITEM	PART NUMBER	DESCRIPTION	100-Series
Figure 10-2			
PTO CLUTCH, PULLEYS, AND CONTROLS			
1	8971	Jack Shaft Housing	1
2	106388	Integral Shaft Bearing	1
3	936021	Retaining Ring	1
4	937089	Nr. 9 Woodruff Key	2
5	112109	Upper Jackshaft Pulley	1
6	108172	Lower Jackshaft Pulley	1
7	909862	Set Screw 5/16-18 x 5/16	4
8	113151	Spacer Plate	1
9	908035	Bolt 3/8-16 x 1-1/4	2
10	915663	E.S. Nut 3/8-16	2
11	112110	PTO Brake Band	1
13	111729	Shoulder Bolt	1
15	111730	Long Shoulder Bolt	1
16	915112	Eslok Nut 5/16-18	2
17	112111	PTO Clutch Lever Assy	1
18	110369	Spacer	1
19	920249	Spacial Washer	1
20	8510	V Idler Pulley	1
21	908041	HHCS 3/8-16 x 2-3/4	1
22	915663	E.S. Nut 3/8-16	2
27	112425	Flat Idler Pulley	1
28	920009	Washer 3/8 SAE	2
29	109779	Jam Nut 3/8-16	1
32	114231	PTO Drive Belt	1
33	111057	PTO Handle	1
35	932008	Cotter Pin 3/32 x 3/4	2
36	9038	Handle Grip	1
37	111676	PTO Handle to Lever Rod	1
38	112113	Compression Spring	1
39	920008	Washer 5/16 SAE	2
40	915662	E.S. Nut 5/16-18	1
41	932008	Cotter Pin 3/32 x 3/4	3
42	111755	Trunnion	1
43	920009	Washer 3/8 SAE	2
44	6651	PTO Brake Spring	1
46	108571	Spring Washer	X
47	112756	PTO Switch Bracket	1
48	915661	E.S. Nut 1/4-20	1
49	908002	Bolt 1/4-20 x 5/8	1
50	915111	Eslok Nut 1/4-20	2
52	112115	Bracket	1
54	2844	Special Washer	1
55	920008	Washer 5/16 SAE	1
56	920007	Washer 1/4 SAE	1
57	908033	Bolt 3/8-16 x 7/8	1

SECTION 11 - SEAT AND SUSPENSION

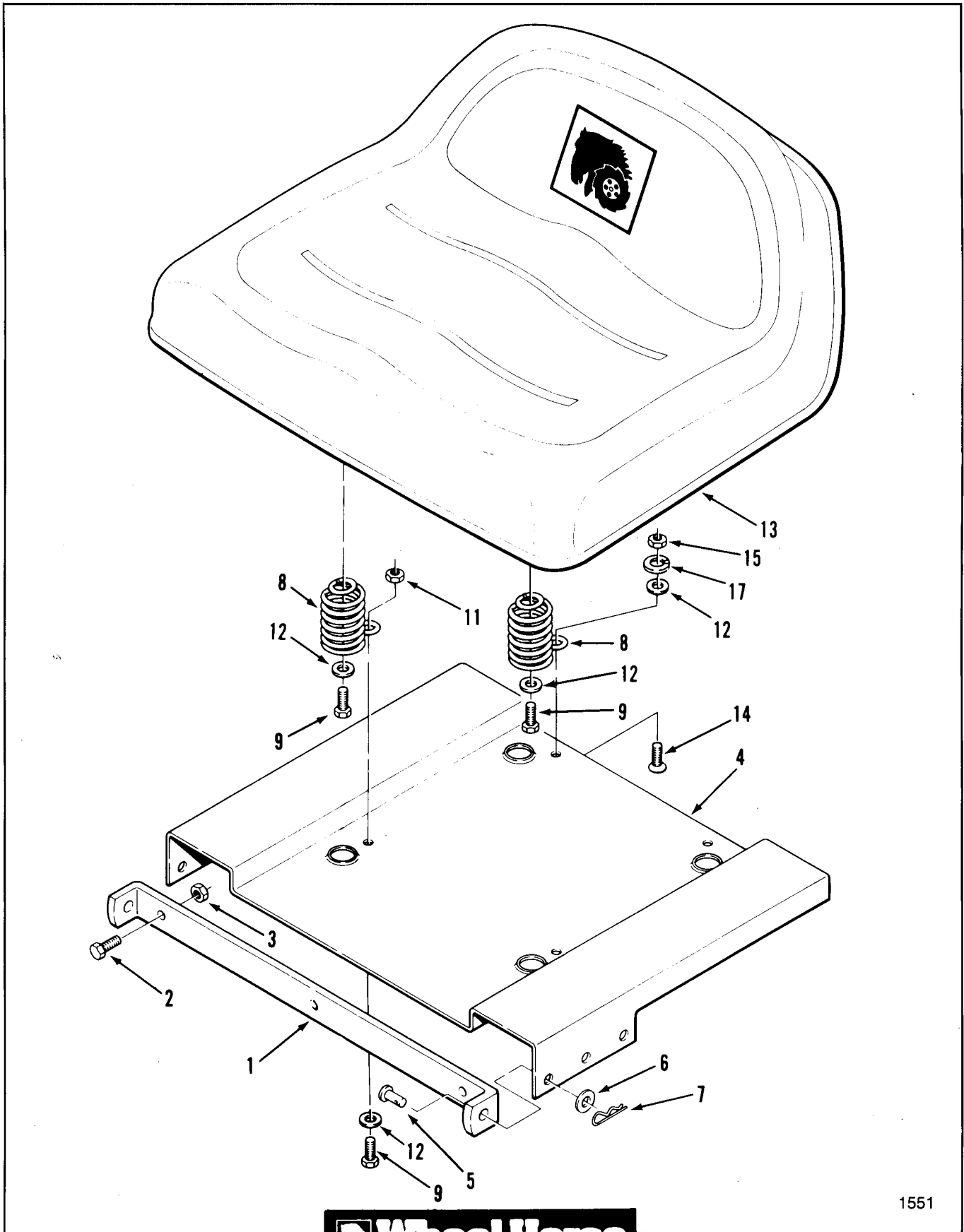

1551

Figure 11-1 Seat and Suspension

SECTION 11 - SEAT AND SUSPENSION

ITEM	PART NUMBER	DESCRIPTION	100-Series
		Figure 11-1	
		SEAT AND SUSPENSION	
1	111064	Seat Mounting Bracket	1
2	908017	Bolt 5/16-18 x 3/4	3
3	915662	Eslok Nut 5/16-18	3
4	113961	Seat Pivot Plate	1
5	932960	Clevis Pin 5/8	2
6	108571	Spring Washer	2
7	933504	Hair Pin Cotter 1 7/16	2
8	111090	Spring	4
9	908017	Bolt 5/16-18 x 3/4	7
11	915662	Eslok Nut 5/16-18	3
12	920008	Washer 5/16 SAE	9
13	105259	Seat 110-4 Only	1
	111393	Seat 112-6 Only	1
	116654	Seat TORO	1
14	908835	Screw 5/16-18 x 3/4	1
15	915112	Nut 5/16-18	1
17	920082	Lockwasher 5/16	1

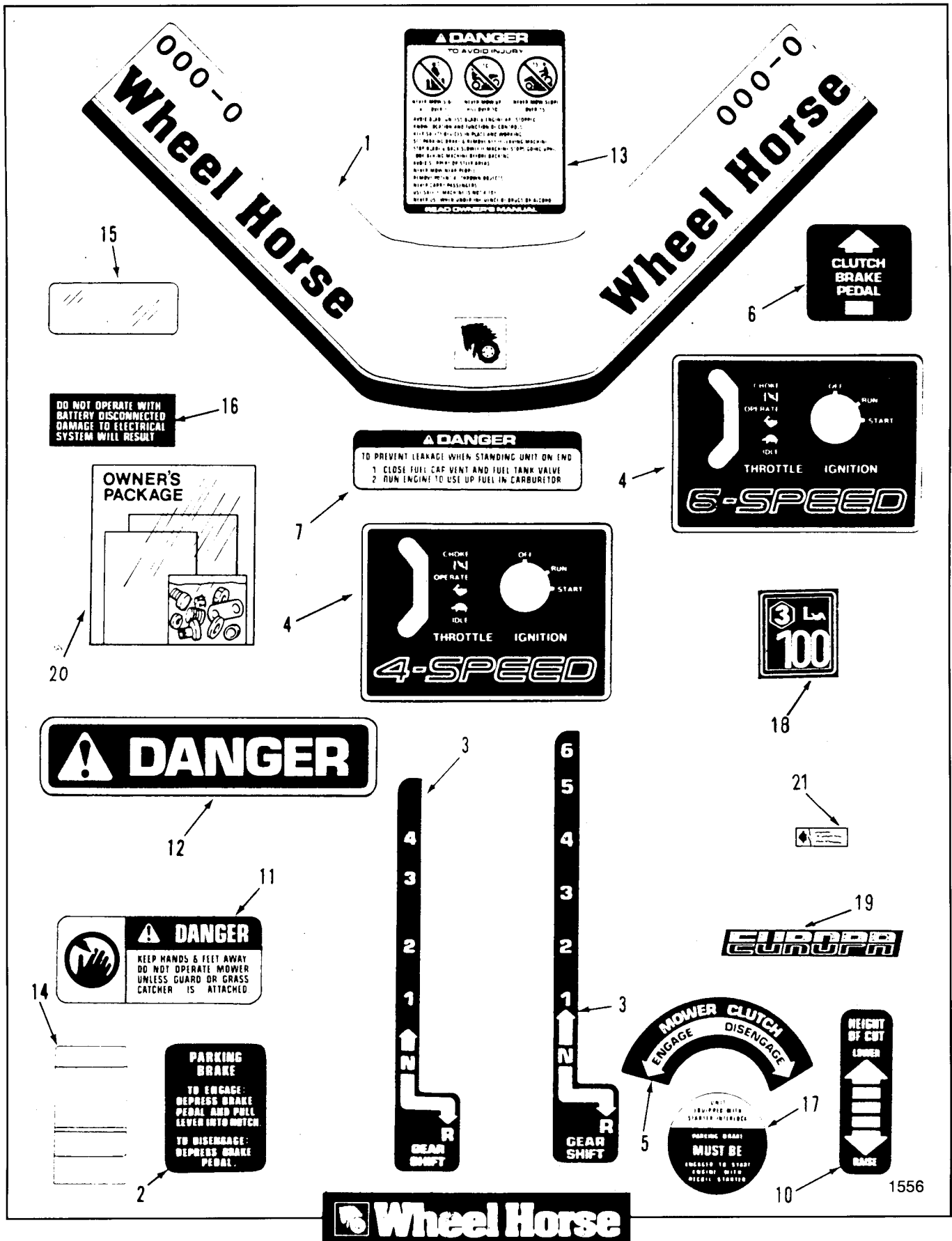

Figure 11-2 Decals and Miscellaneous

SECTION 11 - DECALS AND MISCELLANEOUS

ITEM	PART NUMBER	DESCRIPTION	100-Series
<p>Figure 11-2 DECALS AND MISCELLANEOUS</p>			
1	114924	Front Steering Shroud Decal 110-4 Only	1
	116552	Front Steering Shroud Decal TORO 4-Speed	1
	114913	Front Steering Shroud Decal 112-6 Only	1
	116685	Front Steering Shroud Decal TORO 6-Speed	1
2	111327	Parking Brake Decal	1
	88129	Parking Brake Decal German	1
	88130	Parking Brake Decal French	1
	88131	Parking Brake Decal Dutch	1
3	112140	Shift Decal 4-Speed	1
	88126	Shift Decal 4-Speed Symbol	1
	112180	Shift Decal 6-Speed	1
	88127	Shift Decal Symbol 6-Speed	1
4	112182	Ignition Throttle Decal 110-4 Only	1
	88166	Ignition Throttle Decal Symbol 4-Speed	1
	112181	Ignition Throttle Decal 112-6	1
	88241	Ignition Throttle Decal Symbol 6-Speed	1
5	111635	PTO Decal	1
	88125	PTO Decal Symbol	1
6	111632	Clutch Brake Pedal Decal	1
	79242	Clutch Brake Pedal Decal German	1
	79234	Clutch Brake Pedal Decal French	1
	88124	Clutch Brake Pedal Decal Dutch	1
7	113913	Decal-Fuel Tank Danger	1
	88108	Decal - Fuel Tank Danger German	1
	88109	Decal - Fuel Tank Danger French	1
	88110	Decal - Fuel Tank Danger Dutch	1
10	111655	Mower Height Adjustment Decal	1
	88117	Mower Height Adjustment Decal Symbol	1
11	111188	Decal-Danger Mower	2
	88090	Decal - Danger Mower German	2
	88091	Decal - Danger Mower French	2
	88092	Decal - Danger Mower Dutch	2
12	110422	Decal-Danger	1
	88114	Decal - Danger German	1
	88115	Decal - Danger French	1
	88116	Decal - Danger Dutch	1
13	112670	Decal-Operating Danger	1
	88093	Decal - Operating Danger German	1
	88094	Decal - Operating Danger French	1
	88095	Decal - Operating Danger Dutch	1
14	115398	Decal-Maintenance	1
	88064	Decal - Maintenance German	1
	88063	Decal - Maintenance French	1
	88065	Decal - Maintenance Dutch	1
15	112403	Decal-VIN Overlay	1

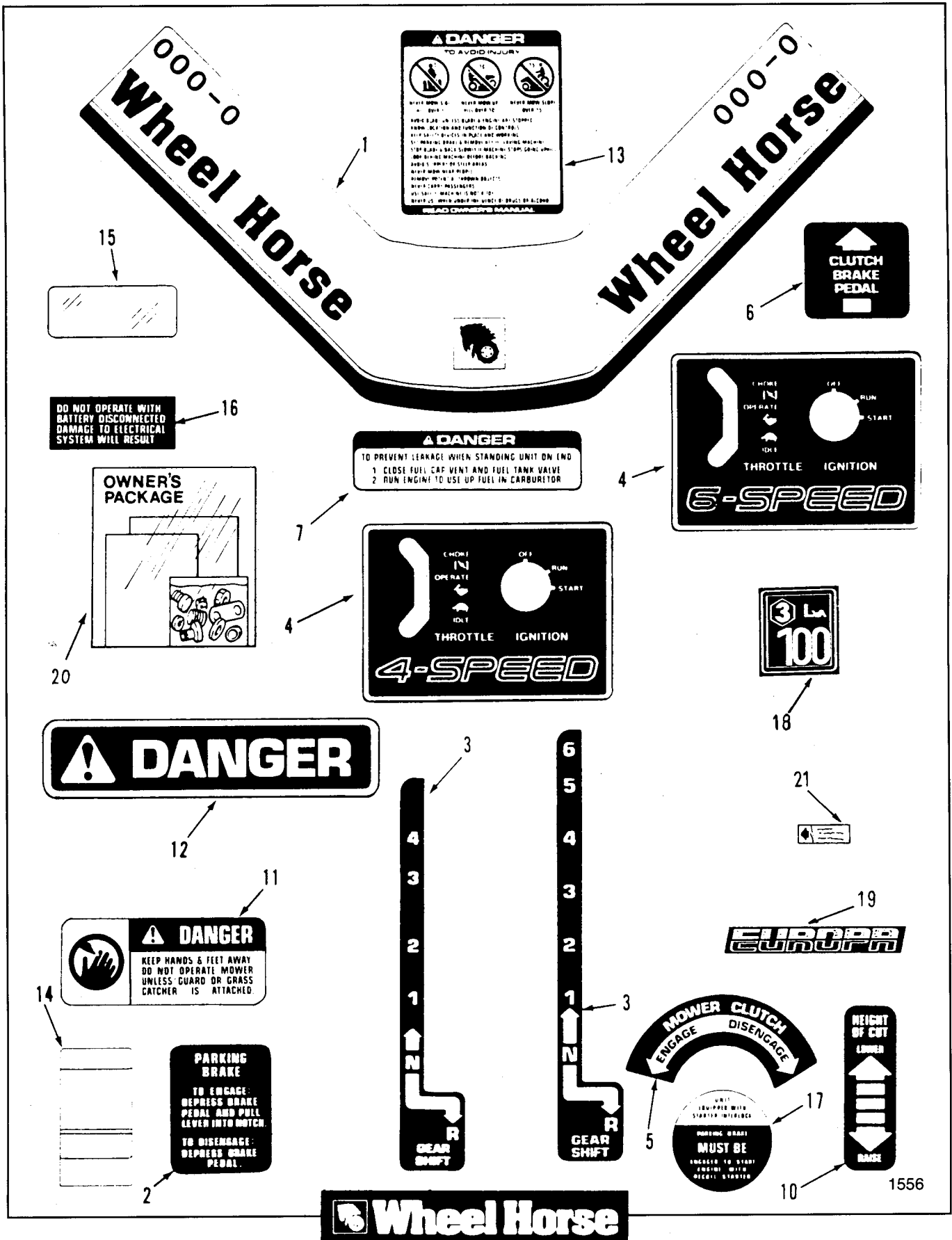
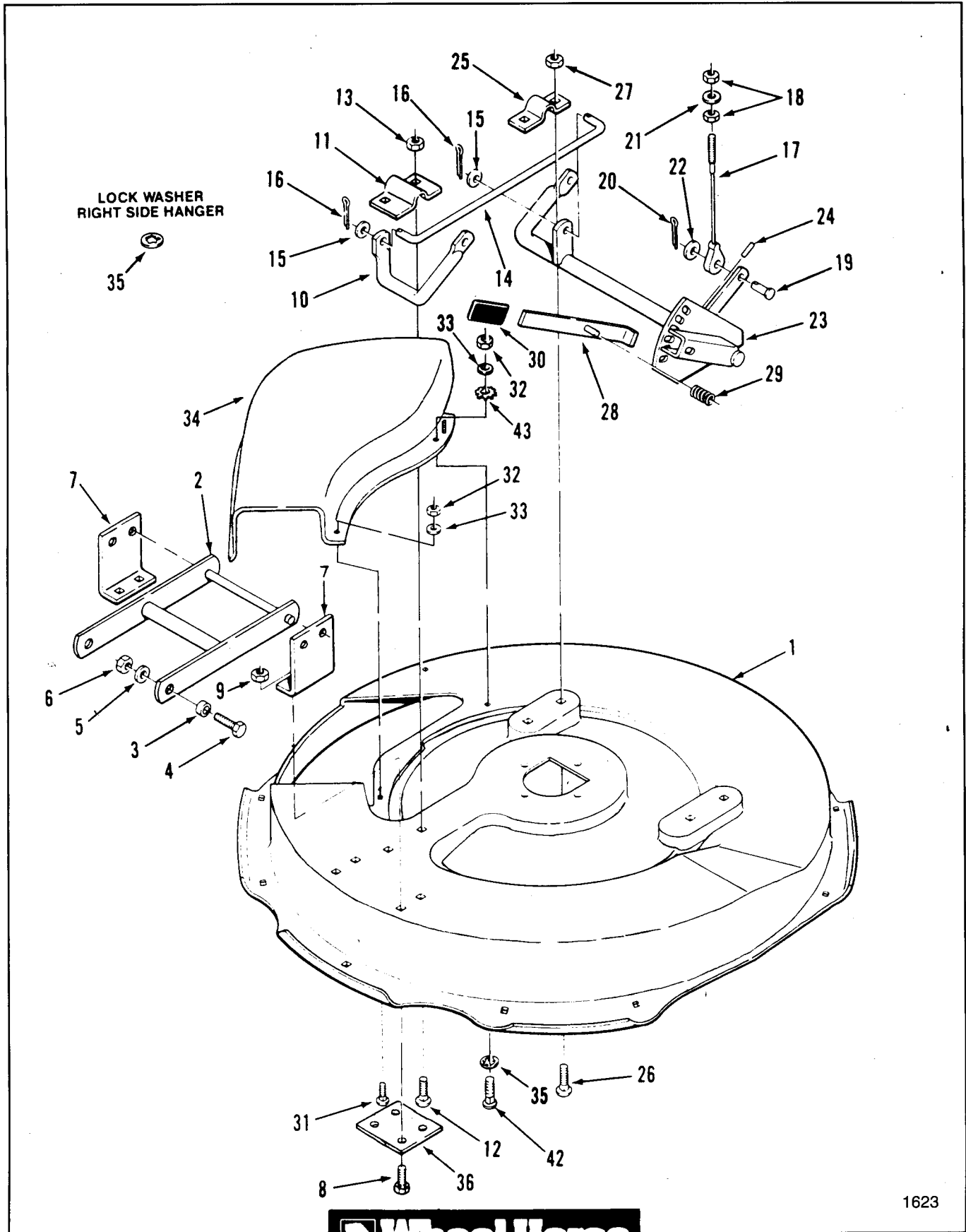

Figure 11-2 Decals and Miscellaneous

SECTION 11 - DECALS AND MISCELLANEOUS

ITEM	PART NUMBER	DESCRIPTION	100-Series
<p>Figure 11-2 DECALS AND MISCELLANEOUS (CONT'D)</p>			
16	111926	Decal-Electrical System	1
	88121	Decal - Electrical Ststem German	1
	88122	Decal - Electrical System French	1
	88123	Decal - Electrical System Dutch	1
17	112734	Decal - Engine Start 112-6 Only	1
18	114621	Decal - Europe Noise	1
19	111342	Decal - Europa	1
20	807192	Loose Parts Pack	1
21	113180	Deacl - PTO Adjustment Indicator	1
	88118	Decal - PTO Adjustment Indicator German	1
	88119	Decal - PTO Adjustment Indicator French	1
	88120	Decal - PTO Adjustment Indicator Dutch	1

SECTION 12 - MOWER DECK AND FRONT MOUNT



1623



Figure 12-1 Mower Deck and Front Mount

SECTION 12 - MOWER DECK AND FRONT MOUNT

ITEM	PART NUMBER	DESCRIPTION	100-Series
Figure 12-1			
MOWER DECK AND FRONT MOUNT			
1	111143	Mower Deck	1
2	110402	Front Mower Mount	1
3	102704	Spacer	2
4	908036	Bolt 3/8-16 X 1-1/2	2
5	920009	Washer 3/8 SAE	2
6	915663	E.S. Nut 3/8-16	2
7	110405	Front Mower Bracket	2
8	908034	Hex Bolt 3/8-16 x 1	4
9	915663	E.S. Nut 3/8-16	4
10	110409	Height Adjustment Rod	1
11	113422	Clamp Note-Offset to Inside	1
12	900063	Carriage Bolt 3/4-16 x 1	2
13	915663	E.S. Nut 3/4-16	2
14	110914	Height Adjustment Rod	1
15	920009	Washer 3/8 SAE	2
16	932008	Cotter Pin 3/32 x 3/4	2
17	110412	Mower Support Cable	2
18	915112	Eslok Nut 5/16-18	4
19	932961	Clevis Pin 3/8 x 3/4	2
20	932008	Cotter Pin 3/32 x 3/4	2
21	920008	Washer 5/16 SAE	2
22	920009	Washer 3/8 SAE (left side only)	1
23	110413	Height Adjustment	1
24	933182	Spirol Pin 3/16 x 5/8	1
25	110841	Clamp	1
26	900063	Carriage Bolt 3/8-16 x 1	4
27	915663	E.S. Nut 3/8-16	4
28	110418	Height Adjustment Lever	1
29	101853	Spring	1
30	102597	Grip	1
31	900014	Carriage Bolt 1/4-20 x 5/8	2
32	915661	E.S. Nut 1/4-20	4
33	920007	Washer 1/4 SAE	4
34	115206	Mower Deflector	1
35	920155	Internal Tooth Lockwasher 5/16	2
36	112736	Front Mounting Plate	1
42	900015	Carriage Bolt 1/4-20 x 3/4	1
43	920122	External Tooth Lockwasher 1/4	1

* "4" At end indicates free - running nut.
DO NOT use Eslok or other type locking nut.

SECTION 12 - SPINDLE, PULLEYS, AND DRIVE BELT

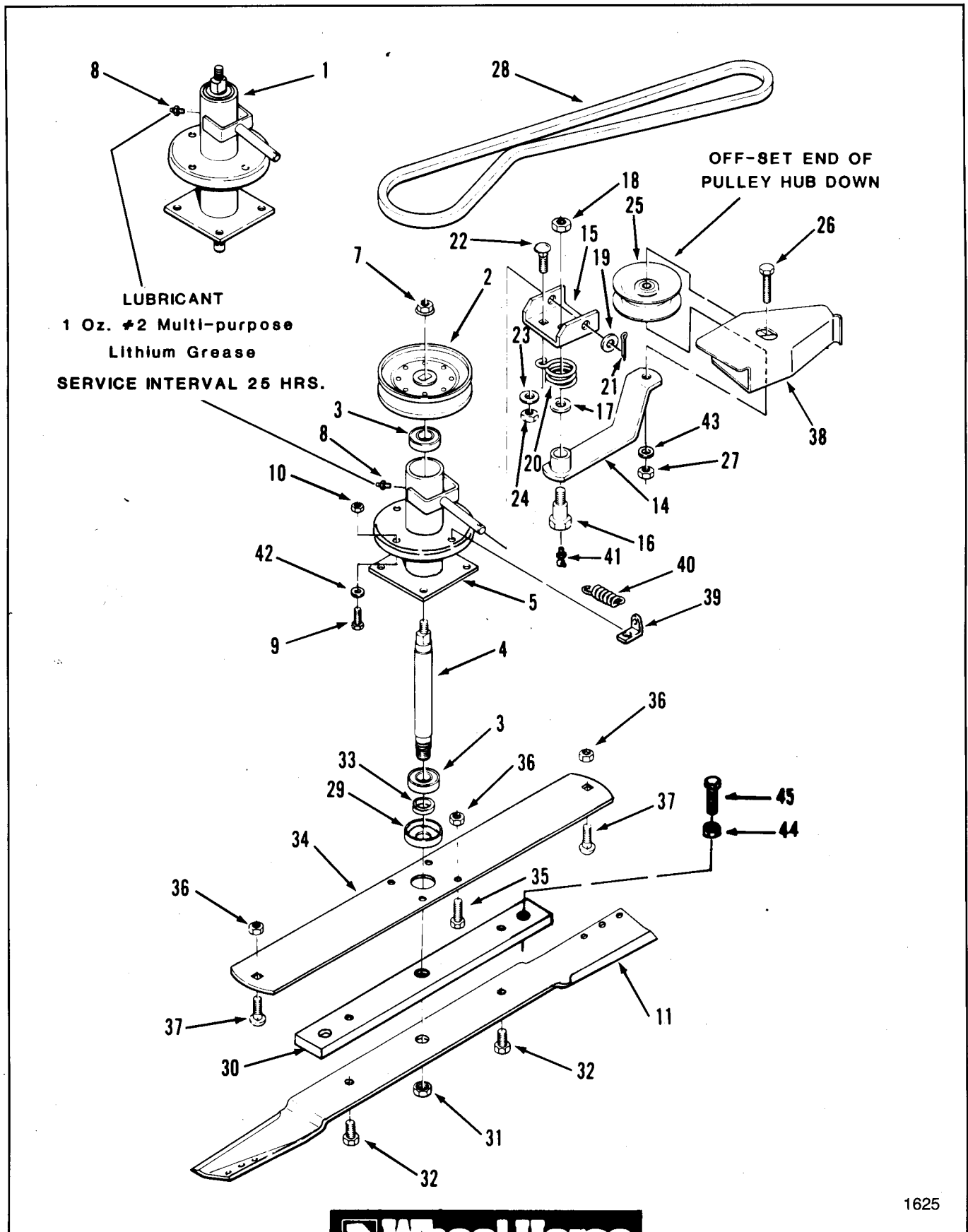

1625

Figure 12-2 Spindle, Pulleys, and Drive Belt

SECTION 12 - SPINDLE, PULLEYS, AND DRIVE BELT

ITEM	PART NUMBER	DESCRIPTION	100-Series
Figure 12-2			
SPINDLE, PULLEYS, AND DRIVE BELT			
1	113168	Spindle Complete (includes items 3, 4, 5 & 8)	1
2	110441	Spindle Pulley	1
3	111135	Spindle Bearing	2
4	111140	Spindle Shaft	1
5	113167	Spindle Housing	1
7	960013	Whiz Lock Nut 3/8-24	1
8	1030	Grease Fitting	1
9	908017	Bolt 5/16-18 x 3/4	4
10	915662	E.S. Nut 5/16-18	4
11	111144	Mower Blade 30"	1
14	110398	Mower Idler Lever	1
15	110400	Pivot Channel	1
16	112125	Shoulder Bolt 7/16-14	1
17	920010	Washer 7/16 SAE	1
18	109996	Jam Nut 7/16-14	1
19	920259	Special Washer	1
20	108177	Torsion Spring	1
21	932008	Cotter Pin 3/32 x 3/4	1
22	900063	Carriage Bolt 3/8-16 x 1	1
23	920009	Washer 3/8 SAE	2
24	915663	Elastic Nut 3/8-16	1
25	110910	Flat Idler Pulley	1
26	908038	Bolt 3/8-16 x 2	1
27	915663	Elastic Nut 3/8-16	1
28	114567	Mower Drive Belt	1
29	111156	Spindle Cup	1
30	113309	Blade Bar	1
31	*9150894	Nut 5/8 UNF	1
32	911440	Bolt 1/2-13 x 3/4 GRD 8	2
33	106068	Spindle Spacer	1
34	111138	Support Plate	1
35	908034	Hex Bolt 3/8-16 x 1	4
36	915663	E.S. Nut 3/8-16	6
37	900233	Carriage Bolt 3/8-16 x 3/4	2
38	111683	Belt Cover	1
39	2534	Clip	1
40	112228	Spring	1
41	1291	Grease Fitting	1
42	920082	Lockwasher 5/16	4
43	2844	Washer	1
44	109779	Hex Jam Nut 3/8-16	2
45	908033	HHCS 3/8-16 x 7/8	2

*3,4" At end indicates free - running nut.
DO NOT use Eslok or other type locking nut.

TORQUE SPECIFICATIONS

BOLT HEAD MARKINGS	BOLT BODY SIZE In. - Thread	SAE GRADE 1 or 2		SAE GRADE 5		SAE GRADE 6 or 7		SAE GRADE 8	
		Torque		Torque		Torque		Torque	
		Ft-Lb	Nm	Ft-Lb	Nm	Ft-Lb	Nm	Ft-Lb	Nm
<p>Manufacturer's marks may vary. Three-line markings on heads shown below, for example, indicate SAE Grade 5.</p> <p>SAE 1 or 2 SAE 5</p> <p>SAE 6 or 7 SAE 8</p>	1/4-20	5	6.8	8	10.8	10	13.6	12	16.2
	.28	6	8.1	10	13.6			14	19.0
	5/16-18	11	15.0	17	23.0	19	25.8	24	32.5
	.24	13	17.6	19	25.8			27	36.6
	3/8-16	18	24.4	31	42.0	34	46.1	44	59.7
	.24	20	27.1	35	47.5			49	66.4
	7/16-14	28	38.0	49	66.4	55	74.6	70	95.0
	.20	30	40.7	55	74.6			78	105.8
	1/2-13	39	52.9	75	101.7	85	115.2	105	142.4
	.20	41	55.6	85	115.2			120	162.7
	9/16-12	51	69.1	110	149.1	120	162.7	155	210.1
	.18	55	74.6	120	162.7			170	230.5
5/8-11	83	112.5	150	203.3	167	226.4	210	284.7	
.18	95	128.8	170	230.5			240	325.4	
3/4-10	105	142.4	270	366.1	280	379.6	375	508.4	
.16	115	155.9	295	400.0			420	569.4	
7/8- 9	160	216.9	395	535.5	440	596.6	605	820.3	
.14	175	237.3	435	589.8			675	915.2	
1- 8	235	318.7	590	799.9	660	894.8	910	1233.8	
.14	250	339.0	660	894.8			990	1342.2	

FUEL line

50' bulk fuel line ID .250 x OD .550 - nr. 112570

FASTENERS

- * All hex bolts GRADE 5 minimum, GRADE 8 used as noted.
- * All carriage bolts GRADE 1 unless otherwise noted.
- * In place of ESLOK or E.S. nuts, use LOCTITE or lock washers with free running nuts.

PAINT

- Red Enamel - 6 cans, order nr. 8-0311
- Red Enamel - Quart can. nr. 5340 (Non-aerosol)*
- Beige Enamel - 6 cans, order nr. 8-0321
- Black Enamel - 6 cans, order nr. 8-0334
- Pewter Metallic Enamel - 6 cans, order nr. 8-0335
- (Automotive Equivalent: 1971 Lincoln-Mercury Pewter Metallic)
- White Enamel - 6 cans, order nr. 8-0336
- Pewter Gray Enamel - 6 cans, order nr. 8-0337
- (Automotive Equivalent: 1982 Lincoln Light Pewter)
- Silver Metallic Enamel - 6 cans, order nr. 8-0338
- Pewter Gray Enamel - Quart can nr. 5347 (Non-aerosol)**

* Thinning - use automotive enamel reducer with zylol (slow drying time) or toluol (fast drying time) - no mineral spirits.

** Thin with zylol